

# China-Italy Conference on Stochastic Analysis

## Welcome to the China-Italy Conference on Stochastic Analysis, August 17-21, 2026

Academy of Mathematics and Systems Science (AMSS), Chinese Academy of Sciences (CAS), Beijing

### Introduction

The purpose of this event is to bring together the researchers in probability communities of China and Italy, as well as experts from other countries, to exchange their latest progresses in the fields of stochastic analysis and statistical physics.

### ✳️ Important Dates 重要日期

August 16-17

On-site Registration  
现场注册

August 17-21

The Conference Dates  
会议日期

### Confirmed Speakers

- ✳️ Oleg Butkovsky, *Weierstrass Institute, Germany*
- ✳️ Xin Chen, *Shanghai Jiao Tong University, China*
- ✳️ Franco Flandoli, *Scuola Normale Superiore of Pisa, Italy*
- ✳️ Tadahisa Funaki, *BIMSA, China*
- ✳️ Lucio Galeati, *University of L'Aquila, Italy*
- ✳️ Ruojun Huang, *Scuola Normale Superiore of Pisa, Italy*
- ✳️ Juan Li, *Shandong University, China*
- ✳️ Xinyi Li, *Beijing University, China*
- ✳️ Xue-Mei Li, *École Polytechnique Fédérale de Lausanne, Switzerland*
- ✳️ Kening Lü, *Sichuan University, China*
- ✳️ Lorenzo Marino, *Scuola Normale Superiore of Pisa, Italy*
- ✳️ Mario Maurelli, *University of Pisa, Italy*
- ✳️ Vahagn Nersesyan, *NYU Shanghai, China*
- ✳️ Umberto Pappalettera, *University of Basel, Switzerland*
- ✳️ Andrea Di Primio, *Scuola Normale Superiore of Pisa, Italy*
- ✳️ Enrico Priola, *University of Pavia, Italy*
- ✳️ Michael Röckner, *University of Bielefeld, Germany*
- ✳️ Marco Romito, *University of Pisa, Italy*
- ✳️ Tommaso Rosati, *University of Warwick, UK*
- ✳️ Jinghai Shao, *Tianjin University, China*
- ✳️ Jian Song, *Shandong University, China*
- ✳️ Leonardo Tolomeo, *Hausdorff Center, Bonn, Germany*
- ✳️ Fengyu Wang, *Tianjin University, China*
- ✳️ Jian Wang, *Fujian Normal University, China*
- ✳️ Hao Wu, *Tsinghua University, China*
- ✳️ Jianliang Zhai, *University of Science and Technology of China*
- ✳️ Deng Zhang, *Shanghai Jiao Tong University, China*
- ✳️ Tusheng Zhang, *University of Science and Technology of China*
- ✳️ Xicheng Zhang, *Beijing Institute of Technology, China*
- ✳️ Rongchan Zhu, *Beijing Institute of Technology, China*

### Advisory Committee 咨询委员会

#### ➤ Chairman 主席

- ✳️ Zhiming Ma 马志明, AMSS, CAS
- ✳️ Jiaan Yan 严加安, AMSS, CAS

#### ➤ Committee Members 成员

- ✳️ Zhao Dong 董昭, AMSS, CAS
- ✳️ Fuzhou Gong 巩馥洲, AMSS, CAS
- ✳️ Xiangdong Li 李向东, AMSS, CAS
- ✳️ Shunlong Luo 骆顺龙, AMSS, CAS
- ✳️ Zhan Shi 施展, AMSS, CAS

### Organizing Committee 组织委员会

- ✳️ Dejun Luo 罗德军, AMSS, CAS
- ✳️ Weiwei Qi 齐维维, AMSS, CAS
- ✳️ Quan Shi 石权, AMSS, CAS
- ✳️ Yongsheng Song 宋永生, AMSS, CAS
- ✳️ Hui Xiao 肖惠, AMSS, CAS
- ✳️ Yuanyuan Xu 许媛媛, AMSS, CAS
- ✳️ Qiang Zeng 曾强, AMSS, CAS
- ✳️ Guohuan Zhao 赵国焕, AMSS, CAS
- ✳️ Xiangchan Zhu 朱湘禅, AMSS, CAS

### Fundings 基金资助

- ✳️ National Natural Science Foundation of China (Nos. 12426205, 12595281)
- ✳️ National Key R&D Program of China (No. 2022YFA1006300)
- ✳️ State Key Laboratory of Mathematical Sciences, AMSS, CAS

### Traffic Information 交通信息

- **Beijing Capital International Airport to Liaoning International Hotel.**

#### Metro

Terminal 2, 3 (Airport line) → Sanyuanqiao 三元桥 (line 10) → Zhichunlu 知春路 (by walking) → Hotel

For information, please go to <https://en.bcia.com.cn/dtjcx.html>

#### Taxis

For information about taxi locations, please go to <https://en.bcia.com.cn/czc.html>

- **Beijing Railway Station to Liaoning International Hotel by Metro**

Beijing Railway Station (line 2) → Xizhimen (line 4) → Zhongguancun (by walking) → Hotel/AMSS

➤ **Beijingnan Railway Station to Liaoning International Hotel by Metro**

Beijingnan Railway Station (line 4) → Zhongguancun (by walking) → Hotel/AMSS

**Hotel** 住宿

All invited speakers will be accommodated at the Liaoning International Hotel (辽宁大厦, on the right side of the map below), located at No. A2, North 4th Ring Road West (北四环西路甲 2 号). Website: <http://en.liaoninghotel.cn/>

Here is the route from Liaoning International Hotel (A) to AMSS, CAS (B)

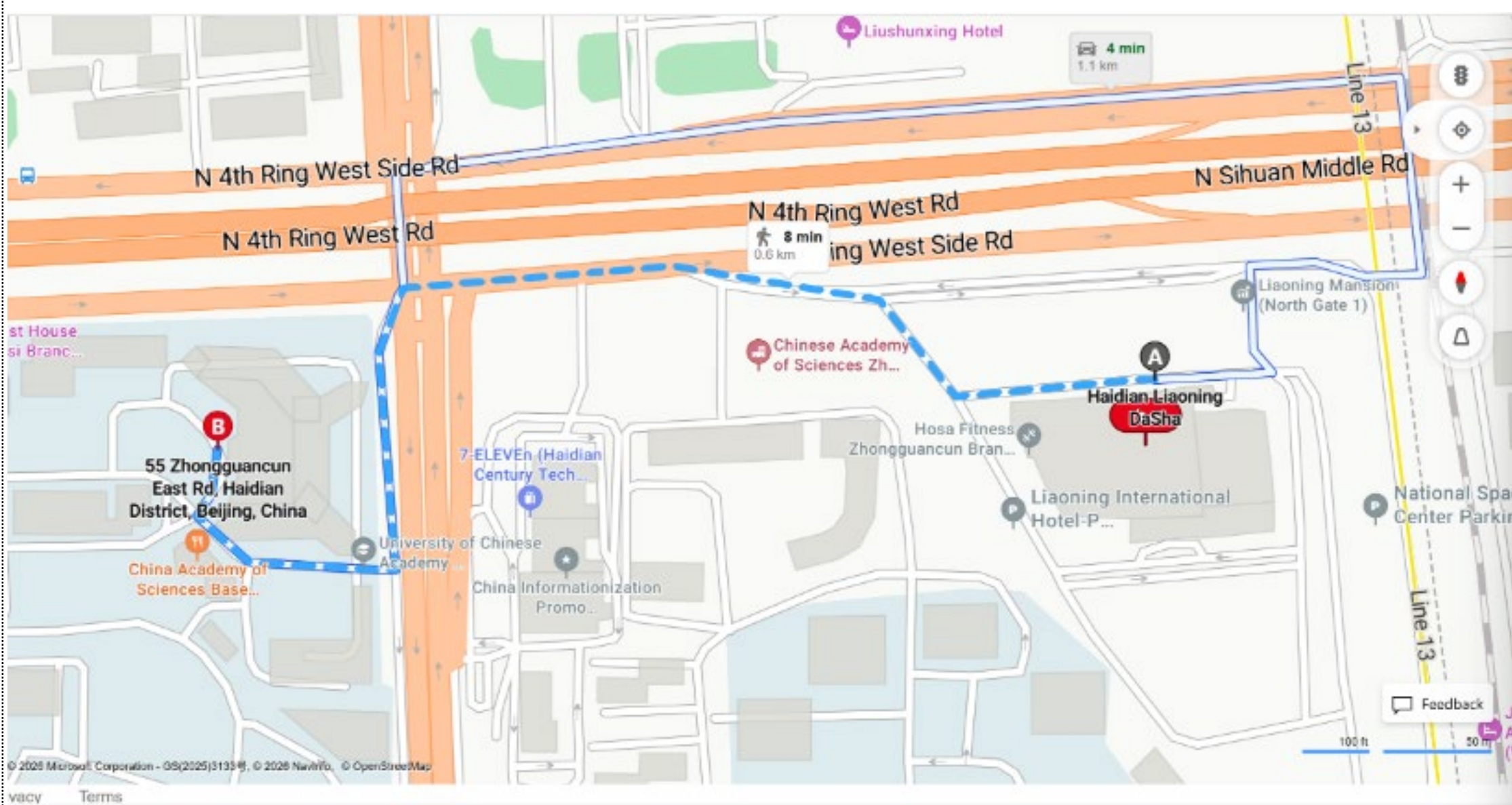

Institute of Applied Mathematics, Academy of Mathematics and Systems Science,  
Chinese Academy of Sciences, Beijing